

General Specifications

Extension Module, Extension Base Unit

DARWIN

GS 04M01E01-21E

Extension Module, Extension Base Unit

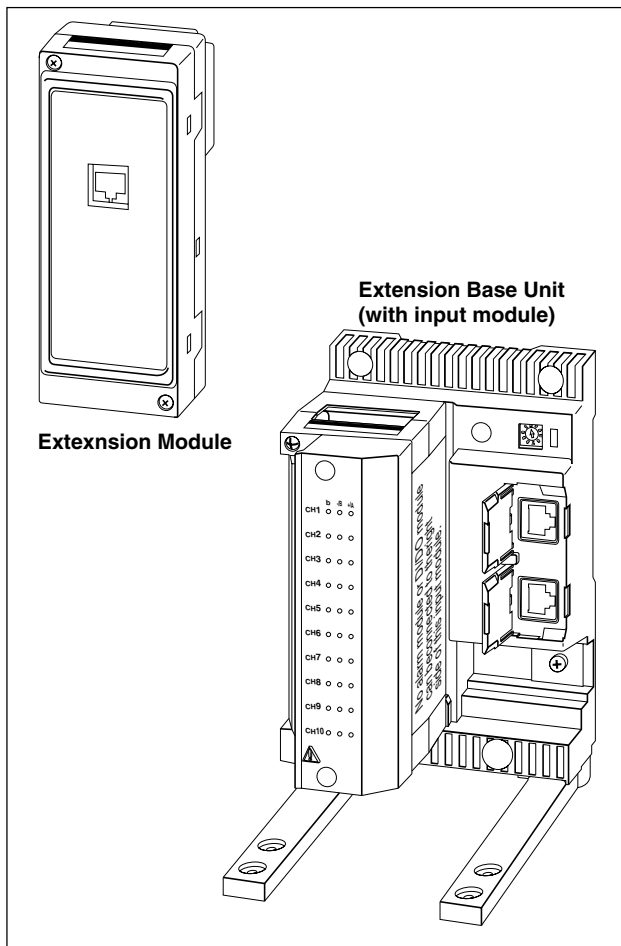

Outline

The extension module and extension base unit allow you to install input modules in locations up to 30 m away from a DA100 data acquisition unit or its sub-units, saving on the number of cables wired to the input modules.

Input modules thus connected are powered through the extension module from a sub-unit.

Extension Equipment's Components:

The extension equipment is composed of an extension module (DV100-011) and extension base unit (DV100-012). The extension module is mounted onto the main unit of a stand-alone DA100-based data acquisition system or a sub-unit (for a DA100 data acquisition unit or expandable DR recorder).

Each input module is mounted onto the extension base unit, where the base unit is wired to the extension module with a dedicated DARWIN cable (DV200-xxx). You can equip each extension module with a maximum of three extension base units and connect a 10-channel universal input module (DU100-1x) or a DCV/TC/DI input module (DU200-1x) to each of these extension base units.

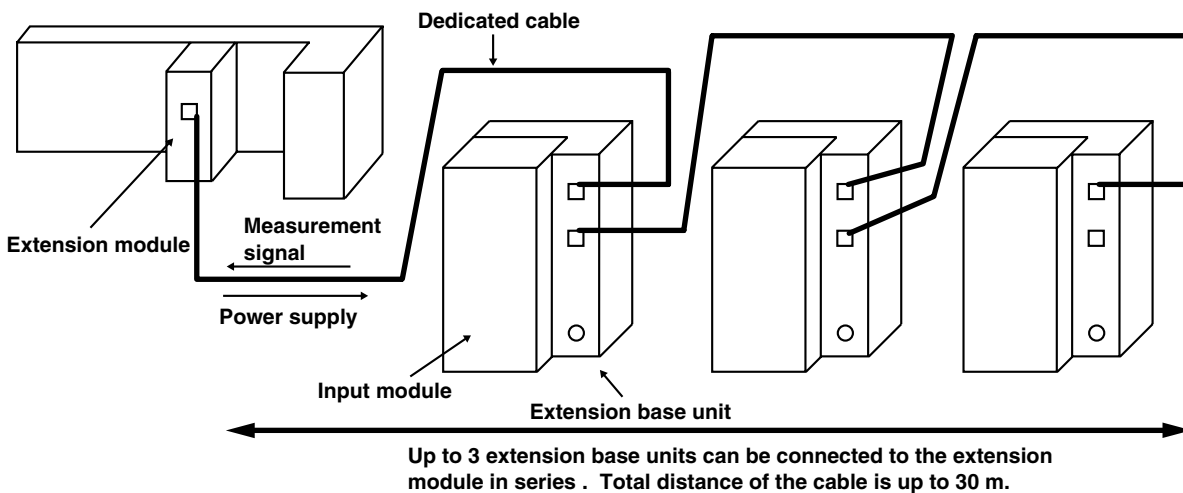

Model code:

Extension module:DV100-011

Extension base unit:DV100-012

The connection of the extension module and extension base unit are not affected by the style number.

Connectable unit of extension module:

DA100 stand alone model: main unit

DA100/DR recorder /DC100 expandable model:

Sub unit(DS400, DS600)

Cannot be used with the DR130, DR231, and DR241

Connectable module of extension base unit:

Universal 10ch module (DU100-1x)

DCV/TC/DI 10ch module (DU200-1x)

Connectable number of extension module:

One module to one main or sub unit.

Connectable number of extension base unit:

Up to 3 units to one extension module in series.

However, the number of input modules mounted on the extension base units and the number of input and/or output modules directly mounted on the main or sub unit where extension module is connected must not exceed total number of modules that can be connected to the main or sub unit.

Total distance of the cable:

less than 30 m

Effective cable:

DV200-xxx(DARWIN dedicated cable)

Normal operating temperature :

-10 to 60°C

Normal operation humidity:

20 to 80%RH(-10 to 40°C)

10 to 50%RH(40 to 50°C)

5 to 30%RH(50 to 60°C)

Insulation resistance:

depends on the mounted module

Dielectric strength:

depends on the mounted module

Power consumption:

included in the main or sub unit to which the module is to be installed

Outside dimensions & Weight

Model and suffix code	Outside dimensions(W) × (H) × (D)	Weight(kg)
DV100-011	Approx:57 × 137 × 50	0.5
DV100-012	Approx:115 × 180 × 143	1.0

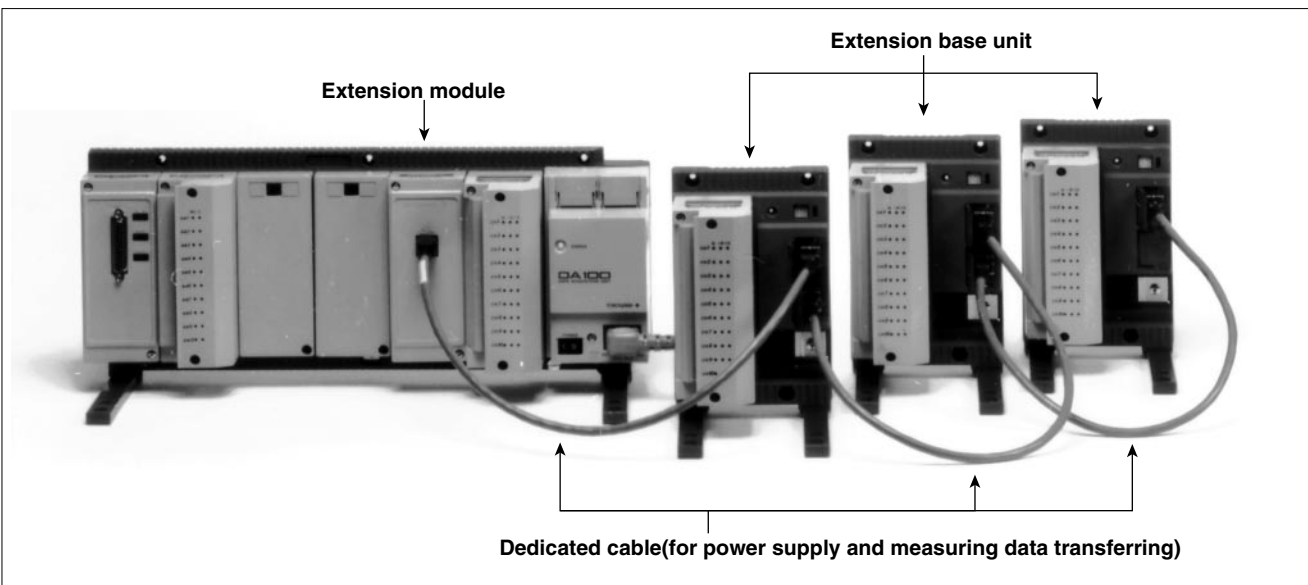

Dimensions
Extension module

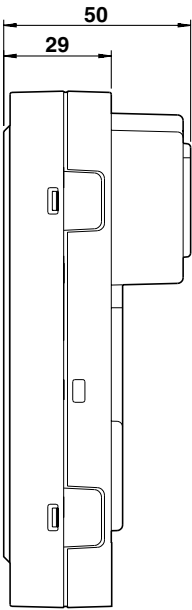
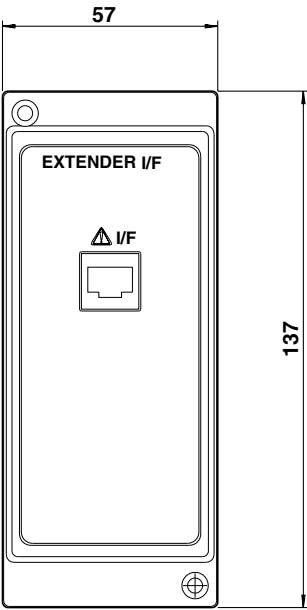
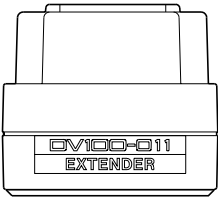

If not specified, the tolerance is $\pm 3\%$. However, in cases of less than 10 mm, the tolerance is ± 0.3 mm

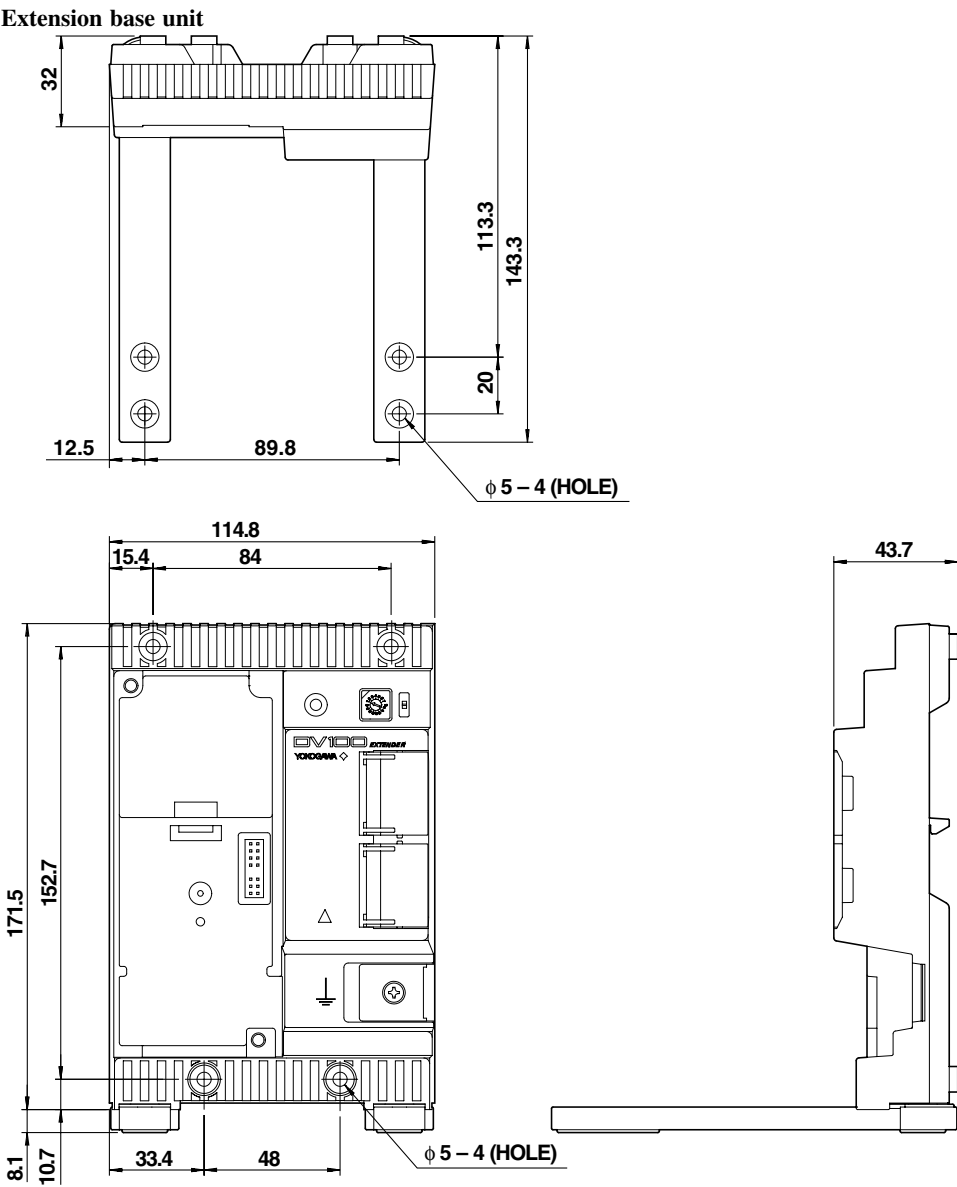

If not specified, the tolerance is $\pm 3\%$. However, in cases of less than 10 mm, the tolerance is ± 0.3 mm